







HiKu7 Mono PERC

580 W ~ 605 W



CS7L-580 | 585 | 590 | 595 | 600 | 605MS-R (IEC1000 V)

CS7L-580 | 585 | 590 | 595 | 600 | 605MS-R (IEC1500 V)

MORE POWER

-  Module power up to 605 W
Module efficiency up to 21.4 %
-  Up to 3.5 % lower LCOE
Up to 5.7 % lower system cost
-  Comprehensive LID / LeTID mitigation technology, up to 50% lower degradation
-  Better shading tolerance

MORE RELIABLE

-  40 °C lower hot spot temperature, greatly reduce module failure rate
-  Minimizes micro-crack impacts
-  Heavy snow load up to 5400 Pa, wind load up to 2400 Pa*



Linear Power Performance Warranty*

12 Years Enhanced Product Warranty on Materials and Workmanship*

**1st year power degradation no more than 2%
Subsequent annual power degradation no more than 0.55%**

*According to the applicable Canadian Solar Limited Warranty Statement.

MANAGEMENT SYSTEM CERTIFICATES*

ISO 9001:2015 / Quality management system
ISO 14001:2015 / Standards for environmental management system
ISO 45001: 2018 / International standards for occupational health & safety

PRODUCT CERTIFICATES*

IEC 61215 / IEC 61730
IEC 61701 / IEC 62716
UNI 9177 Reaction to Fire: Class 1 / Take-e-way
Canadian Solar recycles panels at the end of life cycle



* The specific certificates applicable to different module types and markets will vary, and therefore not all of the certifications listed herein will simultaneously apply to the products you order or use. Please contact your local Canadian Solar sales representative to confirm the specific certificates available for your Product and applicable in the regions in which the products will be used.

CSI Solar Co., Ltd. is committed to providing high quality solar products, solar system solutions and services to customers around the world. Canadian Solar was recognized as the No. 1 module supplier for quality and performance/price ratio in the IHS Module Customer Insight Survey, and is a leading PV project developer and manufacturer of solar modules, with over 59 GW deployed around the world since 2001.

* For detailed information, please refer to the Installation Manual.

ENGINEERING DRAWING (mm)

Rear View

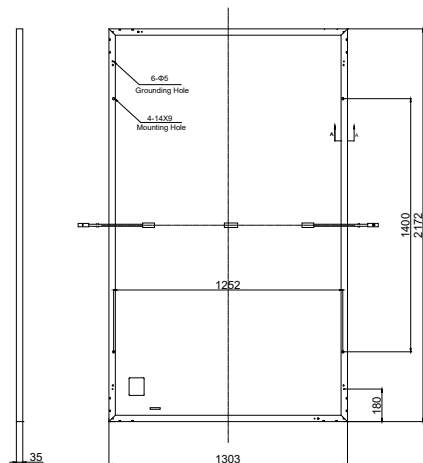

Frame Cross Section A-A

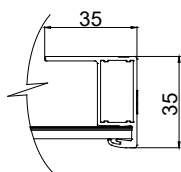

Mounting Hole

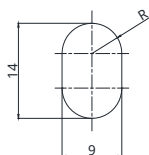

CS7L-590MS-R / I-V CURVES

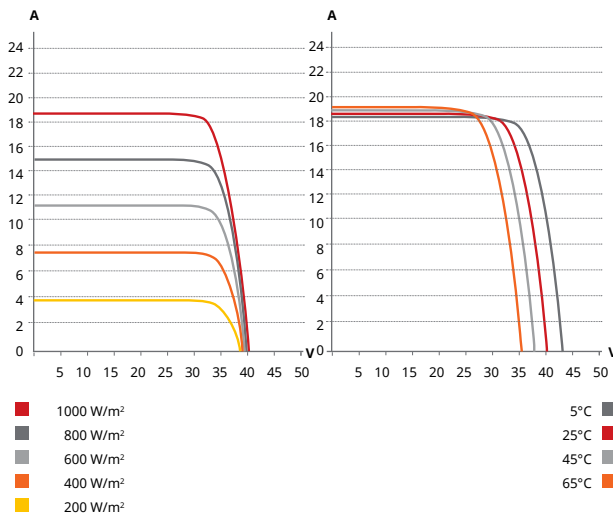

ELECTRICAL DATA | STC*

| CS7L | 580MS-R | 585MS-R | 590MS-R | 595MS-R | 600MS-R | 605MS-R |
|------------------------------|---|---------|---------|---------|---------|---------|
| Nominal Max. Power (Pmax) | 580 W | 585 W | 590 W | 595 W | 600 W | 605 W |
| Opt. Operating Voltage (Vmp) | 34.1 V | 34.3 V | 34.5 V | 34.7 V | 34.9 V | 35.1 V |
| Opt. Operating Current (Imp) | 17.02 A | 17.06 A | 17.11 A | 17.15 A | 17.20 A | 17.25 A |
| Open Circuit Voltage (Voc) | 40.5 V | 40.7 V | 40.9 V | 41.1 V | 41.3 V | 41.5 V |
| Short Circuit Current (Isc) | 18.27 A | 18.32 A | 18.37 A | 18.42 A | 18.47 A | 18.52 A |
| Module Efficiency | 20.5% | 20.7% | 20.8% | 21.0% | 21.2% | 21.4% |
| Operating Temperature | -40°C ~ +85°C | | | | | |
| Max. System Voltage | 1500V (IEC/UL) or 1000V (IEC/UL) | | | | | |
| Module Fire Performance | TYPE 1 (UL 61730 1500V) or TYPE 2 (UL 61730 1000V) or CLASS C (IEC 61730) | | | | | |
| Max. Series Fuse Rating | 30 A | | | | | |
| Application Classification | Class A | | | | | |
| Power Tolerance | 0 ~ + 5 W | | | | | |

* Under Standard Test Conditions (STC) of irradiance of 1000 W/m², spectrum AM 1.5 and cell temperature of 25°C. Measurement uncertainty: ±3 % (Pmax).

MECHANICAL DATA

| Specification | Data |
|------------------------------------|--|
| Cell Type | Mono-crystalline |
| Cell Arrangement | 120 [2 x (10 x 6)] |
| Dimensions | 2172 x 1303 x 35 mm (85.5 x 51.3 x 1.38 in) |
| Weight | 31.0 kg (68.3 lbs) |
| Front Cover | 3.2 mm tempered glass |
| Frame | Anodized aluminium alloy |
| J-Box | IP68, 3 bypass diodes |
| Cable | 6.0 mm ² (IEC), 10 AWG (UL) |
| Cable Length (Including Connector) | 460 mm (18.1 in) (+) / 340 mm (13.4 in) (-) (supply additional jumper cable: 2 lines / Pallet) or customized length* |
| Connector | PV-KST4/xy-UR, PV-KBT4/xy-UR (IEC 1000 V) or PV-KST4-EVO2/XY, PV-KBT4-EVO2/XY (IEC 1500 V) |
| Per Pallet | 31 pieces |
| Per Container (40' HQ) | 527 pieces |

* For detailed information, please contact your local Canadian Solar sales and technical representatives.

ELECTRICAL DATA | NMOT*

| CS7L | 580MS-R | 585MS-R | 590MS-R | 595MS-R | 600MS-R | 605MS-R |
|------------------------------|---------|---------|---------|---------|---------|---------|
| Nominal Max. Power (Pmax) | 435 W | 439 W | 442 W | 446 W | 450 W | 454 W |
| Opt. Operating Voltage (Vmp) | 32.0 V | 32.2 V | 32.3 V | 32.5 V | 32.7 V | 32.9 V |
| Opt. Operating Current (Imp) | 13.60 A | 13.64 A | 13.70 A | 13.73 A | 13.77 A | 13.80 A |
| Open Circuit Voltage (Voc) | 38.3 V | 38.5 V | 38.7 V | 38.8 V | 39.0 V | 39.2 V |
| Short Circuit Current (Isc) | 14.73 A | 14.77 A | 14.80 A | 14.85 A | 14.89 A | 14.93 A |

* Under Nominal Module Operating Temperature (NMOT), irradiance of 800 W/m² spectrum AM 1.5, ambient temperature 20°C, wind speed 1 m/s.

TEMPERATURE CHARACTERISTICS

| Specification | Data |
|--------------------------------------|--------------|
| Temperature Coefficient (Pmax) | -0.34 % / °C |
| Temperature Coefficient (Voc) | -0.26 % / °C |
| Temperature Coefficient (Isc) | 0.05 % / °C |
| Nominal Module Operating Temperature | 41 ± 3°C |

PARTNER SECTION

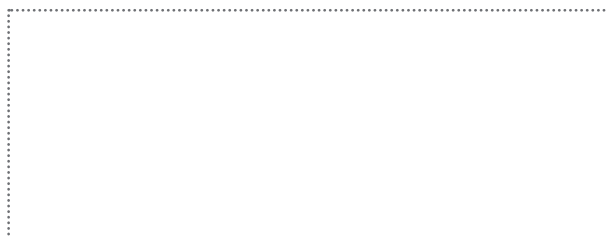

* The specifications and key features contained in this datasheet may deviate slightly from our actual products due to the on-going innovation and product enhancement. CSI Solar Co., Ltd. reserves the right to make necessary adjustment to the information described herein at any time without further notice. Please be kindly advised that PV modules should be handled and installed by qualified people who have professional skills and please carefully read the safety and installation instructions before using our PV modules.

Canadian Solar MSS (Australia) Pty Ltd.

44 Stephenson St, Cremorne VIC 3121, Australia, sales.au@csisolar.com, www.csisolar.com/au

August 2021. All rights reserved, PV Module Product Datasheet V1.8_AU

* Manufactured and assembled in China, Thailand and Vietnam.